

## Idea 4: Playful placemat

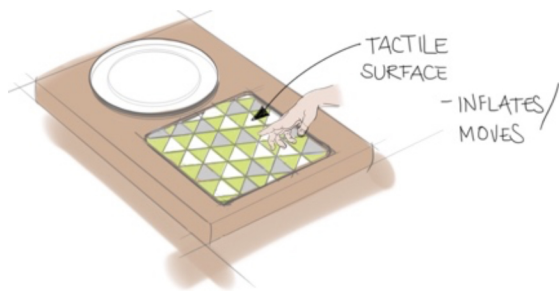

The playful placemat has an integrated interactive and a fabric-based tactile surface. The touchable surface interacts with the user by responding unpredictably when touched: it can move, inflate, or change colour.

## Idea 5: Remote connecting placemat

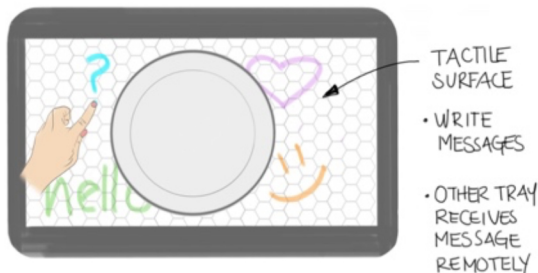

This interactive placemat creates the opportunity to connect with other solo diners using a tactile surface. The user can write a message to other commensals remotely. The message is then portrayed on a remote's diner pairing placemat

when the diner is eating.

## Idea 6: Display tray

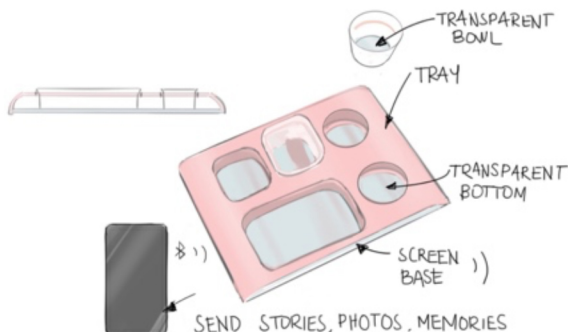

The display tray is a portable display that is attached to a tray with transparent food containers are strategically placed above the display surface. When the food is finished, the displayed media is be visible to the diner. The medis that is portrayed can be pictures or movies with fictive stories or photos/clips of memorable moments.